

# *veritas*<sup>®</sup>

## Scraper Holder



05K33.01

A cabinet scraper is one of the most useful tools in a shop, but can be tiring to use.

The Veritas® Scraper Holder sets the bow in your cabinet scraper, allowing you to scrape effortlessly. Your thumbs no longer get tired or burned during long scraping sessions. Even better, you can easily scrape toward yourself as well as away, letting you work to best advantage with the grain. You can set the scraper to any projection you want; the conical brass clamping plugs have flats on one side for solid scraper support at any projection.

## Loading Your Scraper Holder

Retract the arching screw and release the two locking cone screws. The cones may self-lock in place; just push lightly on top of the locking screws, and the cones will snap out of the taper.

With the scraper holder held inverted in one hand, holding the locking cone screws up, slip your hooked cabinet scraper between the flat portion of the locking cones and the semi-circular pivoting points. (See **Figure 1.**)

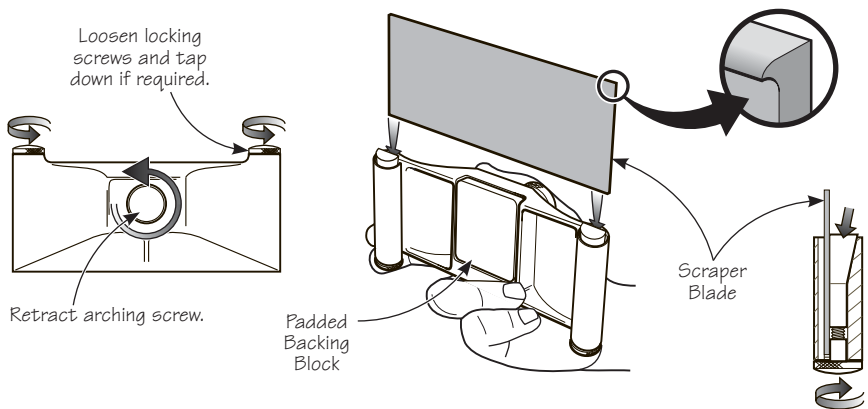

**Figure 1: Inserting a scraper blade into the scraper holder.**

With the cabinet scraper either seated all the way in, or less, if desired, turn the locking screws only until each cone lightly clamps the scraper in place. This is important to allow the cones to still rotate as the scraper is bowed. (See **Figure 2.**)



**Figure 2: Bowing the scraper blade.**

Now turn the arching screw until the scraper is bowed to the curvature you desire, and finally, tighten the two locking screws.

## Using Your Scraper Holder

For very fine work, such as marquetry, you can use the supplied scraper just as it is. For all other work, you should burnish a hook onto the scraper (we recommend the Veritas® Variable Burnisher) before putting it in the holder.

Normally, you would advance the arching screw only about one full turn after it contacts the scraper. This gives you a shallow bow, a fairly wide cutting area, and excellent control. For heavier or very localized scraping, you may want greater bow in the scraper. In general, slight bowing gives you a better finish.

As you turn the arching screw, you will notice that the padded backing block supports the scraper in exactly the same way as your thumbs would (see **Figure 3**). The locking cones pivot, but hold the scraper firmly against the semi-circular pivoting points (see **Figure 2**). The long flats on the cones provide extended support and prevent any scraper chatter. This contact is particularly important when you have the scraper well extended from the holder body, as is sometimes the case when you put a 10° or 15° hook on the scraper (see **Figure 4**). After setting the scraper bow, snug the locking screws on either end of the holder body to ensure maximum support for the blade.

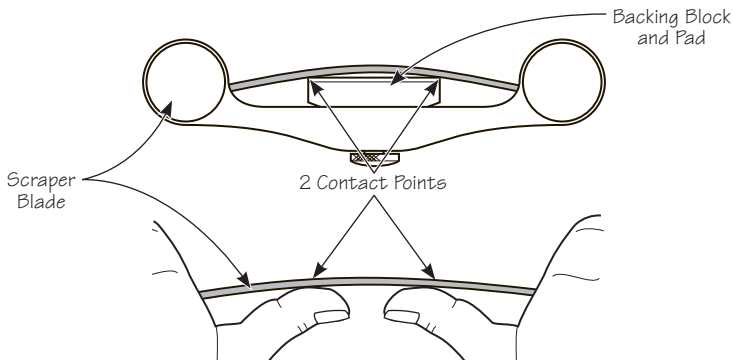

**Figure 3: The backing block supports the scraper the same way your thumbs would.**

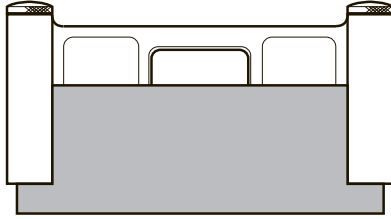

**Figure 4: Scraper extended from holder.**

After your scraping session, it is recommended that you release the tension on the blade and holder by retracting the arching and locking screws.

## **Accessories**

**05K30.10** Set of 4 Super-Hard Milled Cabinet Scrapers

**05K37.01** Veritas® Variable Burnisher

**05M07.01** Veritas® Jointer/Edger

---

**veritas®** Tools Inc.

814 Proctor Avenue      1090 Morrison Drive  
Ogdensburg NY 13669-2205      Ottawa ON K2H 1C2  
United States      Canada

customerservice@veritastools.com

[www.veritastools.com](http://www.veritastools.com)